

EXISTING LAYOUT

- KEY**
- Dropped kerb
 - New kerbline
 - Footway widening
- NOTES**
- 1) All dimensions are shown in metres unless shown otherwise.
 - 2) This drawing shows a proposed option and is subject to change following the location, depth and height of existing utility services.
 - 3) WBC Standard Details must be adhered to at all times unless specified by the Overseeing Organisation.
 - 4) Prior to any excavations the contractor will establish the location of existing utility services.

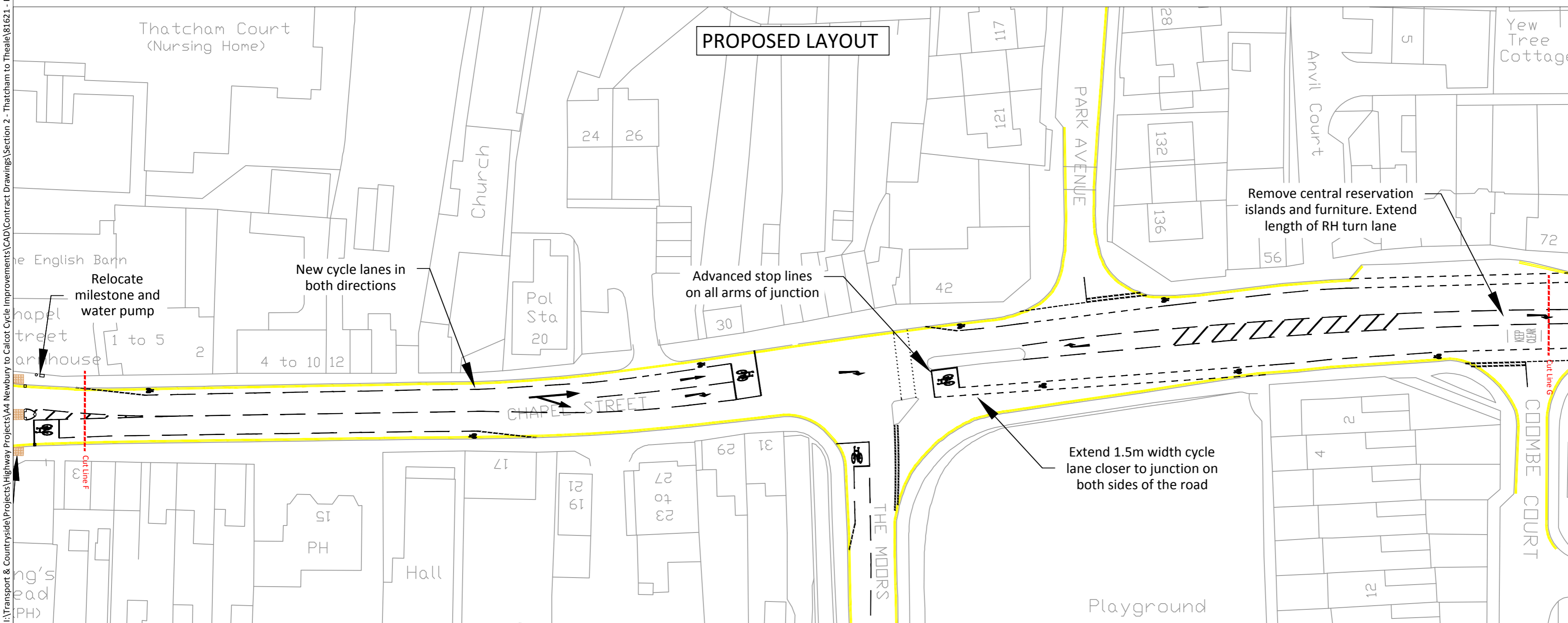

PROPOSED LAYOUT

REV	DESCRIPTION	DR	AU	REV DATE
B				
A				



Project Title				
NCN422 Phase 2 Chapel Street				
Drawing Title				
King's Head PH to Coombe Court (Pg 7 of 13)				
Date	Drawn By	Checked By	Paper Size	Drawing Scale
01/04/18	JBK	NS	A2	1:500
Drawing Number				Revision
81621-Consultation				

I:\Transport & Countryside\Projects\Highway Projects\A4 Newbury to Calcot Cycle Improvements\CAD\Contract Drawings\Section 2 - Thatcham to Theale\81621 - Phase 2 Consultation.dwg